



Hob Moor Oaks Academy

Accessibility Plan 2023-2026

Approved by the School's Local Governing Body on: 26.4.2023 when plan was approved (this should also be noted in the LGB minutes)
To be reviewed: 2026

At Hob Moor Oaks Academy our values reflect our commitment to a school where there are high expectations of everyone. Children are provided with high quality learning opportunities so that each child attains and achieves all that they are able to. Everyone in our school is important and included. We promote an ethos of care and trust where every member of our school community feels that they truly belong and are valued. We work hard to ensure there are no invisible children here, recognising everyone's uniqueness and successes. We recognise learning in all its forms and are committed to nurturing lifelong learners. We are a safe school, committed to improving children's confidence and self-esteem. We know that safe and happy children achieve.

This Accessibility Plan is drawn up in compliance with current legislation and requirements as specified in Schedule 10, relating to Disability, of the Equality Act 2010. On behalf of Ebor Academy Trust; School Governors ensure the implementation, review and reporting of progress of the Accessibility Plan over a prescribed period.

The Equality Act 2010 replaced all existing equality legislation, including the Disability Discrimination Act. The effect of the law is the same as in the past, meaning that "schools cannot unlawfully discriminate against pupils because of sex, race, disability, religion or belief or sexual orientation".

According to the Equality Act 2010 a person has a disability if:

- a) They have a physical or mental impairment, and
- b) The impairment has a substantial and long-term adverse effect on their ability to carry out normal day-to-day activities.

Via the Local Governing Body, Ebor Academy Trust will monitor the school's activity under the Equality Act 2010 (and in particular Schedule 10 regarding Accessibility) and will advise upon the compliance with that duty.



Hob Moor Oaks Academy

Objectives

Hob Moor Oaks Academy is committed to providing an environment that enables full curriculum access that values and includes all pupils, staff, parents and visitors regardless of their education, physical, sensory, social, spiritual, emotional or cultural needs. We are committed to taking positive action in the spirit of the Equality Act 2010 with regard to disability and to developing a culture of inclusion, support and awareness within the school.

The school recognises and values parents' knowledge of their child's disability and its affect on their ability to carry out everyday activities, and respects the parent's and child's right to confidentiality.

This Accessibility Plan shows how access is to be improved for disabled pupils, staff and visitors to the school within a given timeframe and anticipating the need to make reasonable adjustments to accommodate their needs where practical.

The Accessibility Plan contains relevant and timely actions to:-

- Increase access to the curriculum for pupils with a physical disability and/or sensory impairment, expanding the curriculum as necessary to ensure that pupils with a disability are as equally prepared for life as the able-bodied pupils (if a school fails to do this they are in breach of their duties under the Equalities Act 2010). This covers teaching and learning and the wider curriculum of the school such as participation in after-school clubs, leisure and cultural activities or schools visits – it also covers the provision of specialist or auxiliary aids and equipment, which may assist these pupils in accessing the curriculum, within a reasonable timeframe.
- Improve and maintain access to the physical environment of the school, adding specialist facilities as necessary – this covers improvements to the physical environment of the school and physical aids to access education, within a reasonable timeframe.
- Improve the delivery of written information to pupils, staff, parents and visitors with disabilities; examples might include hand-outs, timetables, textbooks and information about the school and school events; the information should be made available in various preferred formats, within a reasonable timeframe.



Hob Moor Oaks Academy

The Accessibility Plan relates to the key aspects of physical environment, curriculum and written information.

Whole school training will recognise the need to continue raising awareness for staff and governors on equality issues with reference to the Equality Act 2010.

The Accessibility Plan for physical accessibility relates to the Accessibility Audit of the School, which remains the responsibility of the governing body and Ebor Academy Trust. It may not be feasible to undertake all of the works during the life of this accessibility plan and therefore, some items will roll forward into subsequent plans. An accessibility audit will be completed by Ebor Academy Trust prior to the end of each period covering this plan in order to inform the development of a new Accessibility Plan for the ongoing period.

Equality Impact Assessments will be undertaken by the school as and when school policies are reviewed. The terms of reference of all governors' committees will include the need to consider Equality and Diversity issues as required by the Equality Act 2010.

The Accessibility Plan will be monitored through Ebor Academy Trust with the Estates and Facilities Manager leading on this.

The Accessibility Plan may be monitored by Ofsted during inspection processes in relation to Schedule 10 of the Equality Act 2010.



Hob Moor Oaks Academy

It is a requirement that the school's accessibility plan is resourced, implemented, reviewed and revised as necessary and reported on annually. Attached is a set of action plans showing how the school will address the priorities identified in the plan.

The priorities for the Accessibility Plan for our school were identified by:

- **Ebor Academy Trust via the Executive Headteacher/Estates and Facilities Manager**
- **Headteacher**
- **Inclusion Leader**
- **School Business Manager**
- **Site Manager/Caretaker**

A plan of the school buildings showing areas of accessibility is shown on the following page.



Hob Moor Oaks Academy

Hob Moor Oaks and Hob Moor Primary Academies
including Hob Moor Children's Centre

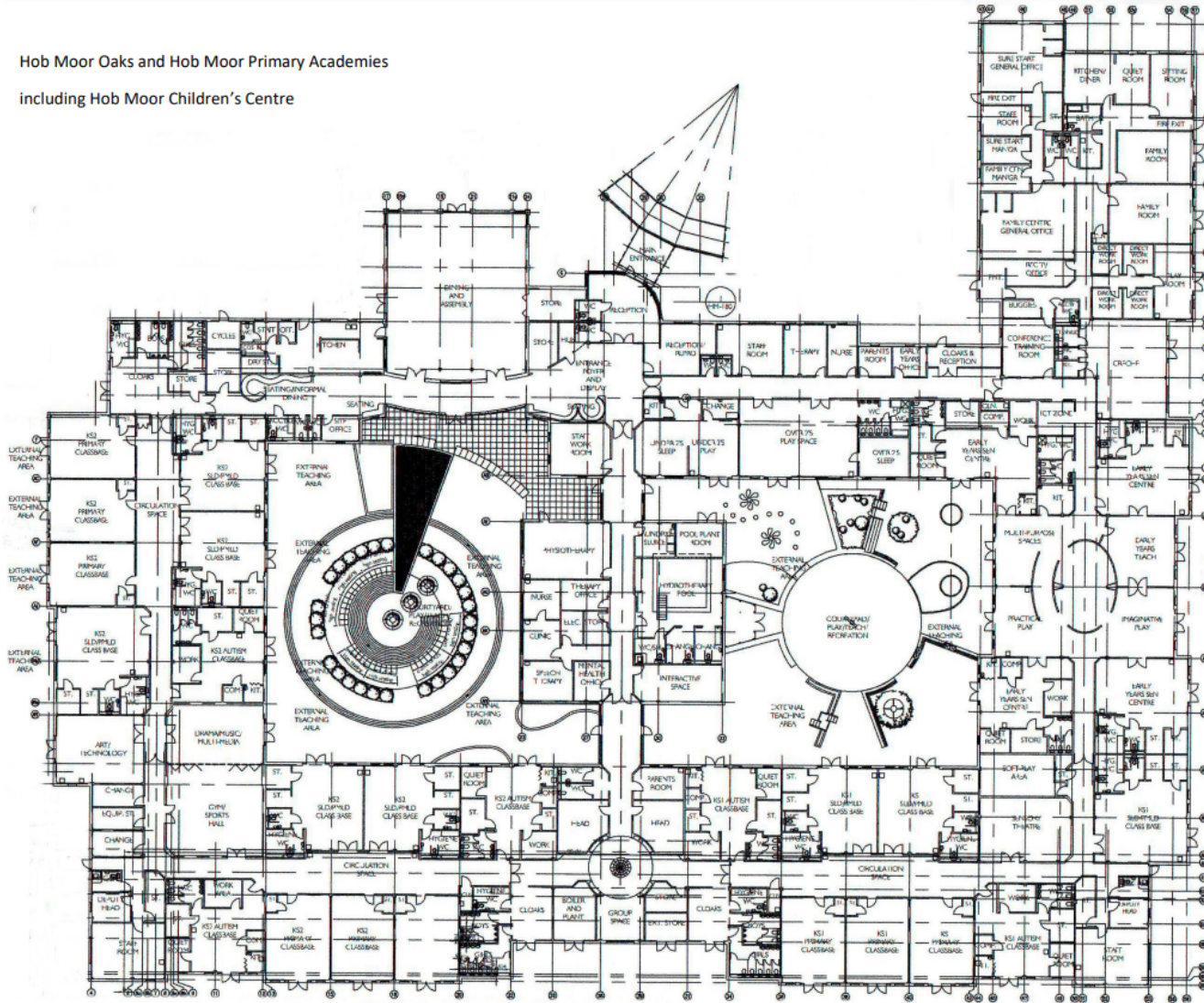



Hob Moor Oaks Academy

Physical Access

Access Report Ref.	Item	Activity	Person(s) responsible	Timescale	Evaluation
1.1	To offer specialist provision for children with SEND in an inclusive environment, with particular focus in Physical Development.	Audit of experience, training and confidence and CPD needed. Identify HLTA to work alongside PE lead to improve the access and delivery of our Physical Development Curriculum.	SLT/ PE Leader/ PE HLTA	Ongoing	
1.2	Ensure access to the Sensory Garden for all pupils attending HMO.	Make adaptations to the access, pathways and facilities with our sensory garden for wheelchair users and children with physical difficulties.	Head Teacher/ Sewells /	Ongoing	
1.3	To provide a mobile hoist for children with physical difficulties to safely access Rebound.	Purchase a new hoist with the appropriate height maximum to enable staff to hoist and support pupils onto the Rebound trampoline.	School Staff/ PE Lead	Annually in Sept -ongoing	
1.4	Ensure there is 'total' communication around the school and school grounds.	All pupils have access to core boards in all areas of school with particular focus on the outdoor continuous provision.	SLT/ Sewells/ Class teams	Annually in Sept -ongoing	



Hob Moor Oaks Academy

Teaching and Learning Access

Access Report Ref.	Item	Activity	Person(s) responsible	Timescale	Evaluation
2.1	Ensure a universal offer of 'Makaton' is available to all pupils, staff and families.	CPD for Staff Access to a 'total' communication environment daily Parent workshops for Level 1+2	Outreach Lead/ Teaching staff	Ongoing	
2.2	To improve the quality of displays to evidence the pupils' learning and progress.	EAD leader to audit policy, training and confidence and CPD needed. Accessible print, tactile resources and access required for all pupils.	EAD Lead/ Teaching staff	Ongoing	
2.3	Improve the pupil voice for children with SEND	Provide opportunities for children to be involved in the target setting process. Ask for opinions on targets and in the construction of Pupil Passports	SENCO	Initially in September	



Hob Moor Oaks Academy

Accessing Information

Access Report Ref.	Item	Activity	Person(s) responsible	Timescale	Evaluation
3.1	Ensure all families (from all local authorities) have support from our Wellbeing Team to access relevant services.	Parents and Carers informed of signposting and access to information so that they understand what they are consenting to and/or be supported through processes.	Wellbeing (WEB) Team	As necessary	
3.2	Identify EAL families to make arrangements available to them so that they have access to information, with particular focus on Annual Reviews of EHCPs.	Ensure EAL families positively contribute their views and access support in the in a way that they will be able to read and understand	SLT/ EHCP Admin Officer/	As necessary	
3.3	Update inclusion page on website	Parents/Carers (current and prospective) have access to all information regarding Inclusion at Hob Moor Oaks Academy	SLT	Ongoing	